



# Jojo



Specification Guide

# Jojo

The Jojo Electric Height-Adjustable + Folding is the latest table system from Thinking Works.

It's unique oval profile, sitting, standing and storage functionality provides countless possibilities and flexibility to suit any workplace environment.

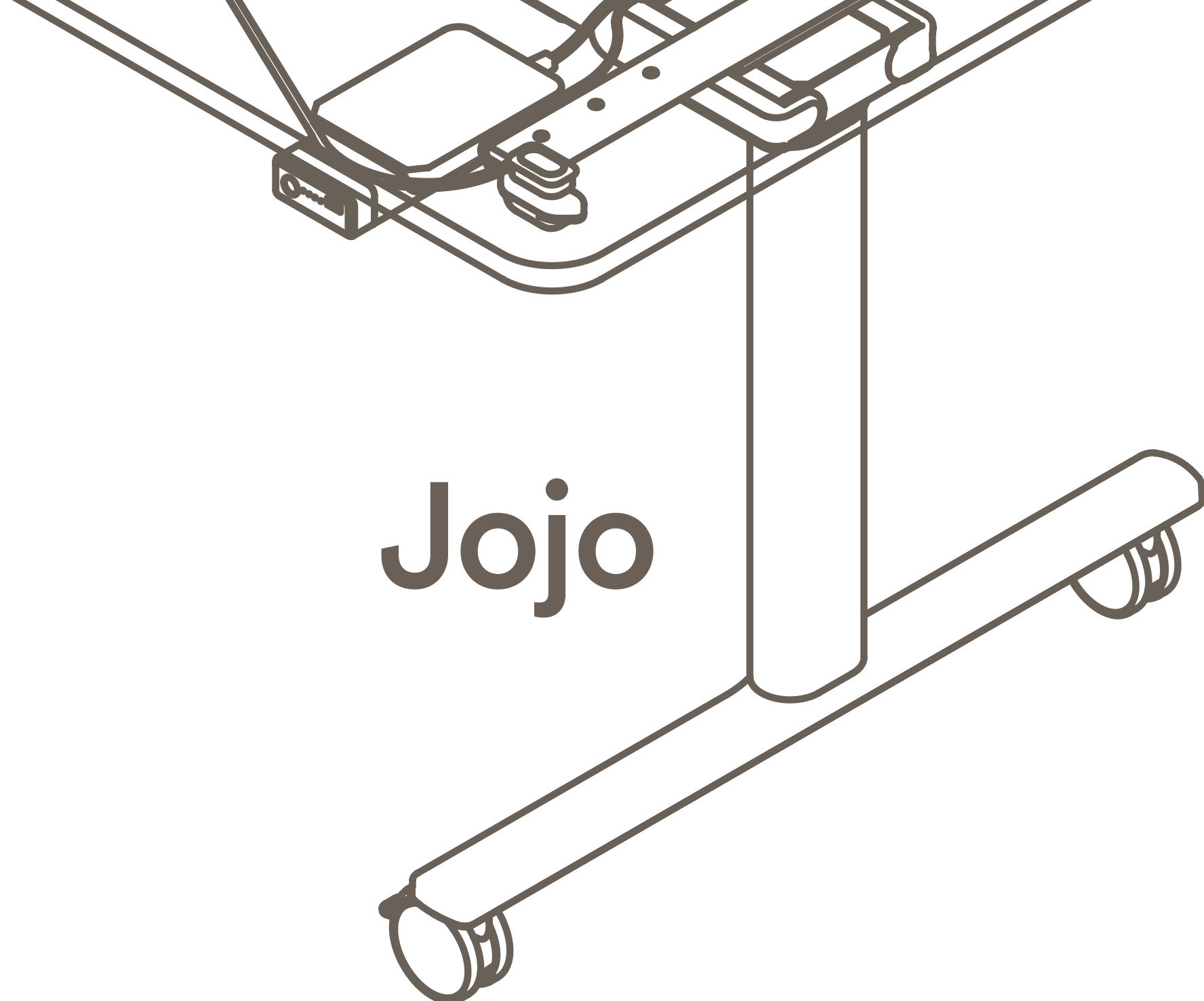

**Jojo**

# Jojo Finishes

## 1. Frame Powdercoat

All steel frame is available in Noir and Blanc powdercoat.

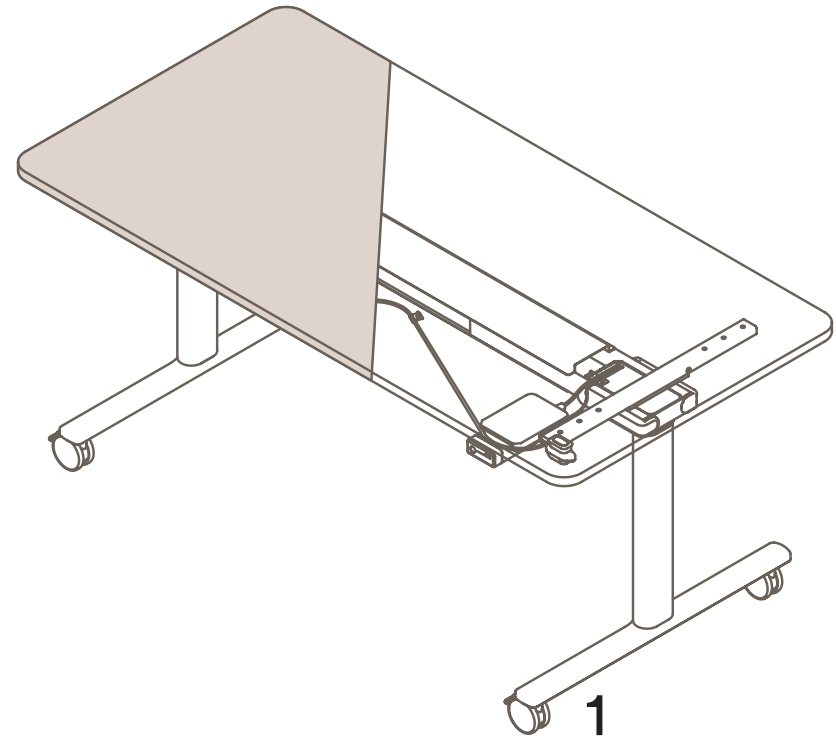

Colours are representative only, please check with your Thinking Works consultant to view samples of any specific colour.

# Jojo Features

---

## Dimensions

Minimum Height            710mm  
Maximum Height           1330mm  
*(Dimensions to underside of worktop)*

Weight Capacity           45kg

*(Evenly Distributed Load including worktop)  
(Maximum Point Load 30kg)*

---

## Functions

- Soft touch silicon handset with up + down control
- Rechargeable battery system for wireless operation
- Built-in Impact Stop Function
- 3 Stage lifting Column with Spindle Drive
- Travel Speed = 35mm/Second
- Noise <50dB
- Castor feet for office mobility

---

## Battery System

- Lithium Ion battery pack with 2.2AH capacity
- 40 up/down cycles from a charged battery
- 4 LED indicator shows remaining charge
- Audible “beep” when battery needs charging
- Worktop mounted for insertion and removal
- USB port for charging mobile phones
- Battery standby power consumption 0.1W

---

## Warranty

Electric Frame            10yrs  
Electrical Components   5yrs

---

## Country of Origin

Australia

For additional Technical Information, please check with your local Thinking Works consultant.

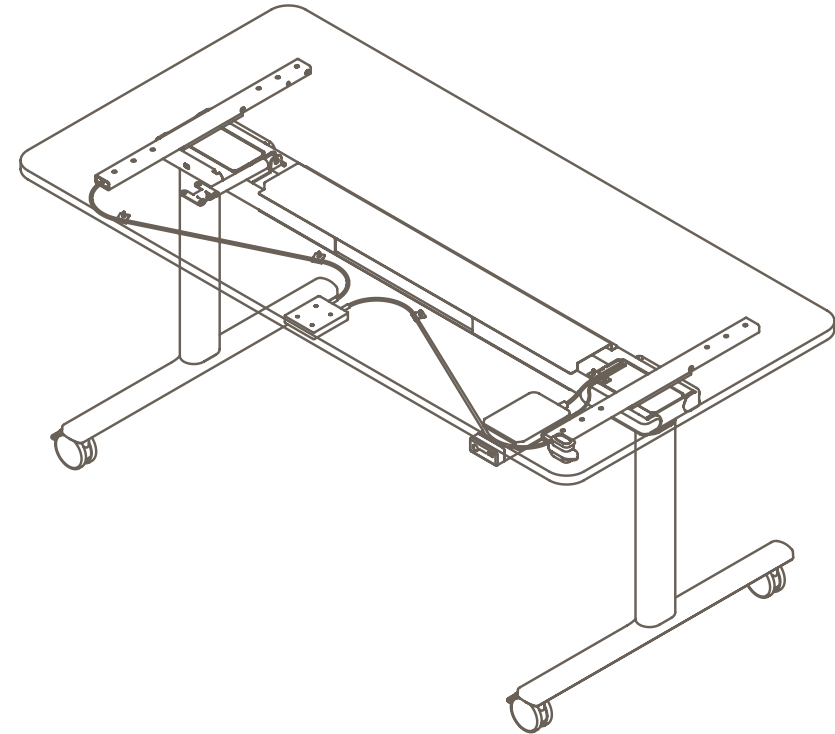

# Jojo

## Electric Height Adjustable + Folding

### Materials Information

JJE-1000

#### Frame Finish

Powdercoat Steel

- a. Noir
- b. Blanc

#### Castor Finish

- a. Black
- b. White

#### Control Box & Handset Finish

- a. Black

#### Operating Noise Level

<50Db

#### Height Range

710mm to 1330mm to underside of worktop

#### Travel Speed

35/mm per second

#### Battery System

40 up/down cycles from a charged battery

#### Handset

Soft touch silicon handset with up + down control

Maximum inc. worktop      45kg  
Maximum Point Load      30kg

#### Notes:

\* Worktops 1200-1800mm long have 130mm overhang at ends of the table.

Worktops 1801-2000mm long have longer overhang at the ends of the table up to 230mm.

\*\*Folded footprint of table is 750mm wide. Each additional stacked table adds 220mm.

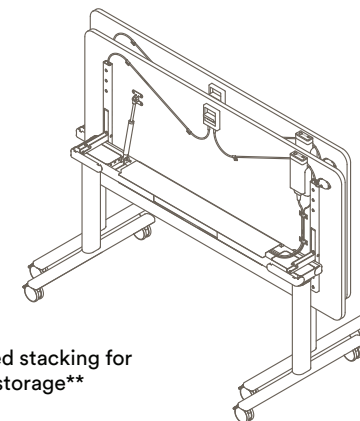
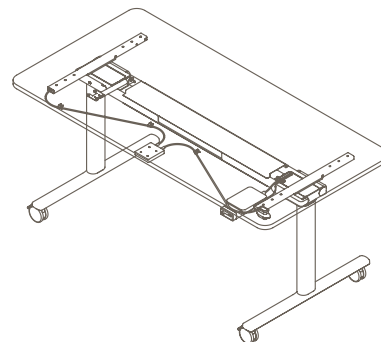
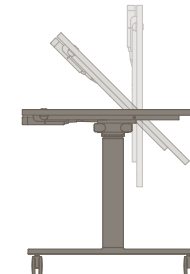
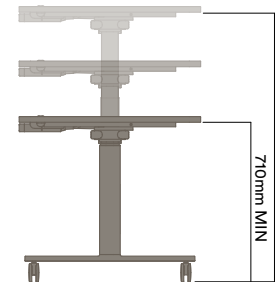
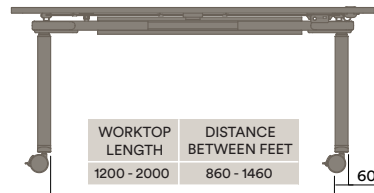
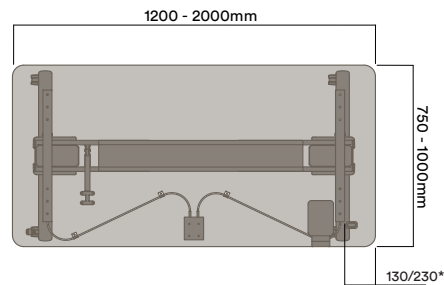

Nested stacking for easy storage\*\*

**info@ergostyle.co.nz**  
**03 366 8810**

**Christchurch showroom now located at**  
**1091 Ferry Road, Ferrymead**  
**Genius Co-Working**